

SOLDERING IRON
ESD-SAFE & TEMPERATURE-CONTROLLED

OPERATION
INSTRUCTION

English

Made in China

● This product should not be thrown in the garbage. In accordance with the European directive 2012/19/EU, electronic equipment at the end of their life must be collected & returned to an authorized recycling facility. ● Este producto no debe desecharse en la basura. De acuerdo a la directiva europea 2012/19/EU, los equipos electrónicos al final de su vida se deberán recoger y trasladar a una planta de reciclaje autorizada. ● Dieses Produkt sollte nicht mit dem Hausmüll entsorgt werden. In Übereinstimmung mit der europäischen Richtlinie 2012/19/EU müssen elektronische Geräte am Ende ihrer Lebensdauer eingesammelt und einem autorisierten Recyclingbetrieb zugeführt werden.

Thank you for purchasing this product. Please read the manual carefully before operating and keep this manual for future reference.
Statement: The company reserves the right to improve & upgrade products, product specifications and design are subject to change without notice.

I. APPLICATIONS

Suitable for soldering and desoldering operations on a broad range of surface-mount, and through-hole components such as SOP, DIP, SOIC and more.

II. APPLICATIONS

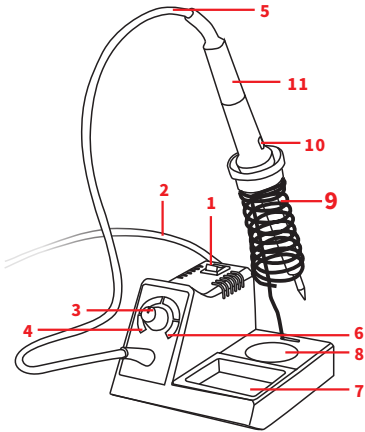

1. Power Switch

2. Power Cord

3. Temperature Adjustment Knob

4. MIN (Lowest Temperature Setting)

5. Cord (Soldering Iron)

6. MAX (Maximum Temperature Setting)
7. Residual Tray (Optional
Cleaning Kit Available)

8. Slot (Cleaning Kit)

9. Holder (Soldering Iron)

10. Operation Indicator

11. Soldering Iron

III. OPERATION

- Place the soldering iron into the holder, and connect the station's power cord to an electrical outlet.
- Turn ON the power switch, and the heating element will begin heating as per normal. Adjust the temperature adjustment knob to set the desired temperature, and begin operating once the temperature reaches the set temperature.

CAUTION: Upon the first use of the soldering iron tip, set the temperature to 250°C/482°F. When the iron is just hot enough to melt the solder, coat the tip with a layer of solder (the use of rosin core solder is recommended), then set the temperature to your desired value.

- After use, use a wet cleaning sponge or a brass wool ball to clean the residues off the soldering iron tip. Tin the soldering iron with a new layer of solder, and place the soldering iron back to the soldering iron holder. If the soldering iron is not in use for an extended period, turn OFF the power switch.

IV. MAINTENANCE & PRECAUTIONS

- If a layer of oxidization forms on the surface of the soldering iron tip, a misconception can be created that the soldering tip cannot heat up properly to melt the solder and do the tinning. However, the actual temperatures of both the heating element and soldering tip are high. In such an instance, please do not increase the temperature value confusedly but use a metal wool ball to remove the oxidization following the steps below:
A. Set the temperature to 300°C (572°F).
B. Once the temperature stabilizes, gently rub the soldering iron tip inside the metal wool ball.
C. When the oxidization is partially removed, continue applying solder onto the tip while rubbing it until the soldering tip is completely coated with solder. If the tip is too severely oxidized beyond cleaning, replace the tip with a new one.
- DO NOT use metal files to remove the oxidization on the soldering iron tip. If the soldering iron tip deforms or rusts, replace the soldering iron tip with a new tip.
- DO NOT apply excessive forces on the soldering tip when soldering. Doing so will not only damage the iron tip but also not improve the heat transfer.
- When placing the soldering iron back in the holder to idle after a high-temperature operation, adjust the temperature to 250°C (482°F) or below for idling. Failure to do so, and leaving the soldering iron tip to idle on a high-temperature setting will cause the accelerated aging of the heating element and shorten the lifespan of the heating element and soldering iron tip.
- After every operation, wipe off the soldering iron tip, and tin the tip with a new layer of solder to prevent oxidization.

V. TROUBLESHOOTING GUIDE

The operation indicator turns ON, but the soldering iron is not heating up – This is an indication that the heating element is malfunctioning. To resolve this issue, you need to replace the heating element.

SPECIFICATION

Model Number	926
Rated Voltage Range	220V~240V/AC,50Hz
Rated Power	35W/45W/60W(Select ONLY one power rating for each model)
Main Unit Dimensions	L140xW115xH90mm ± 5mm
Operating Ambient Temperature	0°C~40°C/32°F~104°F
Display	LED
Tip to Ground Resistance	<2 Ohms
The Guide to the Temperature Adjustment Indications(For 60W)	MIN ≈ 200°C/392°F
	Between ≈ 330°C/626°F
	MAX ≈ 500°C/932°F

IMPORTANT SAFEGUARDS

When using electrical appliances, basic safety precautions should always be followed including the following:

CAUTION!!! WARNING!!!

Read instruction manual before using.

- To provide continued protection against risk of electric shock, connect to properly grounded outlets only.
- Do not immerse in water.
- Hot Surface. Avoid Contact.
- Shock Hazard. To provide continued protection against electric shock disconnect from the power supply when not in use.
- Heat gun, soldering iron, desoldering iron must be placed on its stand when not in use.
- HOUSEHOLD AND INDOOR USE ONLY.
- To prevent electric shock, unplug before replace the fuse and other service.
- Replace only with same type and rating of fuse.
- This appliance is not intended for use by persons (including children) with reduced physical, sensory or mental capabilities, or lack of experience and knowledge, unless they have been given supervision or instruction concerning use of the appliance by a person responsible for their safety.
- Children should be supervised to ensure that they do not play with the appliance.
- The soldering iron and desoldering iron is only to be used with the power supply unit provided with the appliance.
- If the SUPPLY CORD is damaged, it must be replaced by the manufacturer, its service agent or similarly qualified persons in order to avoid a hazard.
- Any servicing should be performed by an authorized service representative AND that the product has no user serviceable parts.
- To reduce the risk of fire or electric shock, do not expose this product to rain or moisture. Store indoors. Read instruction manual before using.
- A fire may result if the appliance is not used with care, therefore
 - be careful when using the appliance in places where there are combustible materials;
 - do not apply to the same place for a long time;
 - do not use in presence of an explosive atmosphere;
 - be aware that heat may be conducted to combustible materials that are out of sight;
 - place the appliance on its stand after use and allow it to cool down before storage;
 - do not leave the appliance unattended when it is switched on.
- To ensure personal safety, please turn off the power switch after work is completed; When not in use for an extended period, please unplug the power cord!!!
- The soldering iron should only be used for soldering. Do not hit the soldering iron against the work surface to remove flux residues (Can be cleaned by the cleaning device of the product), as doing so may seriously damage the soldering iron.
- Soldering produces fumes, ensure there is adequate ventilation.
- After used, remember that cooling the unit, the handle should be placed on the handle holder.
- Longer detachable power-supply cords are available and may be used if care is exercised in their use.
- If a long detachable power-supply cord is used:
 - The marked electrical rating of the detachable power-supply cord or extension cord should be at least as great as the electrical rating of the appliance;
 - The extension cord should be a grounding type 3-wire cord;
 - The longer cord should be arranged so that it will not drape over the countertop or tabletop where it can be tripped over, snagged, or pulled on unintentionally (especially by children).
- A short power-supply cord(or short detachable power-supply cord)is provided to reduce the risks resulting from becoming entangled in or tripping over a longer cord.

SAVE THESE INSTRUCTIONS

Please read Operation Instruction in Part Two.